

## 4" & 5" R-Seal

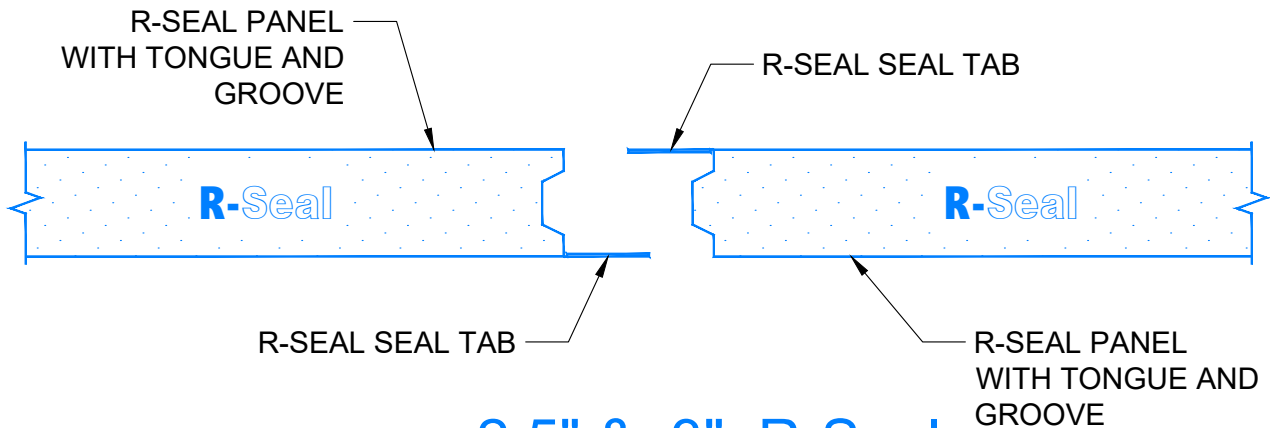

## 2.5" & 3" R-Seal

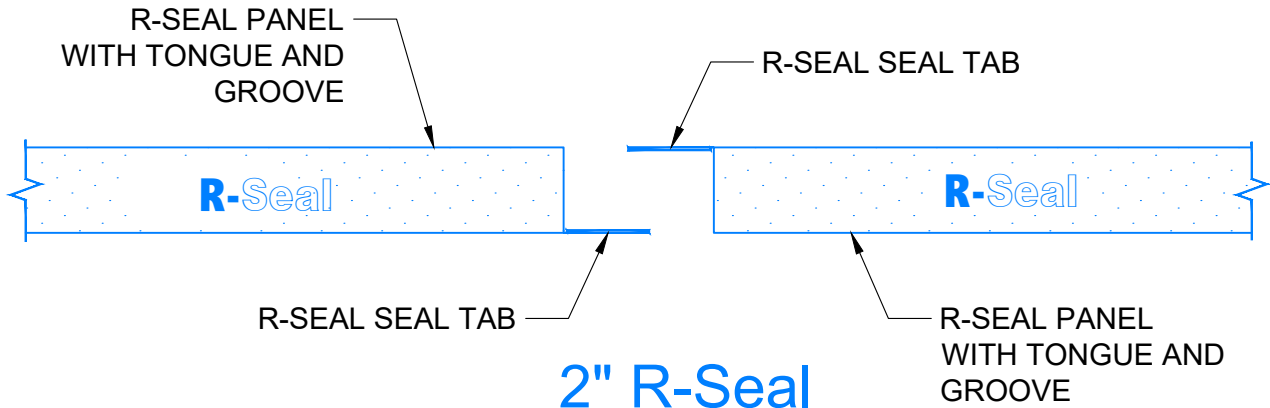

## 2" R-Seal

The information contained in this detail and the accompanying material is thought to be reliable and correct, but is subject to change without notice. Pacific Insulation Products assumes no responsibility for engineering or design of any structures or sub-structure, whether such structure contains products manufactured or supplied by Pacific Insulation Products or not. Typical details are meant to show the product to the seller in a manner which is representative of the way in which they are installed. It is the responsibility of the buyer or his/her architect or engineer to verify that any product is suitable for the conditions and use intended and that he products are compatible with any material.

ISSUE:	DWN:	CHK:	ENG:	MFG:	DATE:

R-SEAL  
 MBI SIDE LAP DETAIL

STANDARD AIR BARRIER



PO BOX #250  
 SULTAN, WA 98294

877-300-3794  
 SALES@R-SEAL.COM